

# M23 Series

- M23/923 male socket
- Description:M23/923 heavy load square male socket, solder type

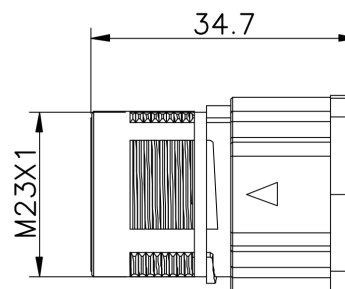

## Assembly Instruction

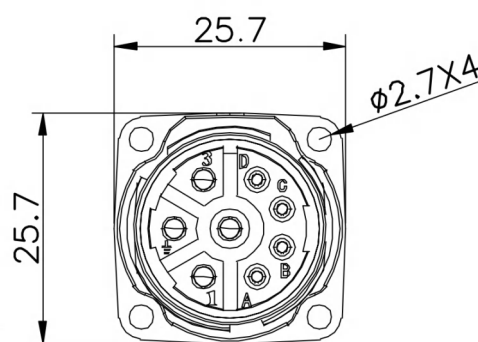
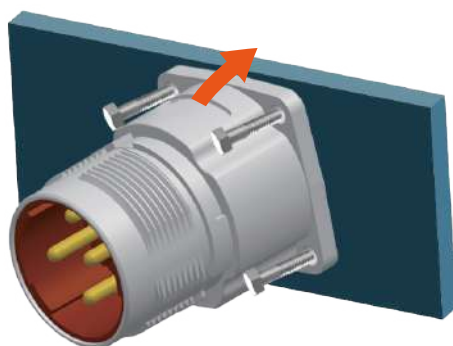

## Technical Data

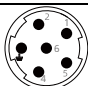
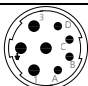
| Pin No.                  | 6   | 8   |
|--------------------------|---|---|
| Pin for reference        |  |  |
| Coupling                 | Threaded coupling   |   |
| Rated current            | 30A   | 9A/20A  |
| Rated voltage            | 630V  | 250V/630V   |
| Operating Temperature    | -20℃~85℃  |   |
| Degree of protection     | IP67  |   |
| Termination              | Solder  |   |
| Mechanical operation     | >500 mating cycles  |   |
| Contact resistance       | $\leq 3m\Omega$   |   |
| Material of contact      | CuZn/CuSn(brass/bronze)   |   |
| Contact plating          | Au(gold plating)  |   |
| Material of contact body | PET (UL 94 V-0)   |   |
| Material of housing      | CuZn(brass,nickel plated)   |   |
| Wire gauge               | 14AWG   | 20AWG   |

## Order Information

| ■ Part No.  | ■ Model No. |
|---|-------------|
| M23-M- <input type="text"/> -923-S<br>Pin No.               | RG92303     |
| Remark:Contact us any time if you have custom requirements. |             |