

- M12 female panel mount connector ,straight.
- Description:M12 female front panel mount connector , M16 fastening thread ,PCB type

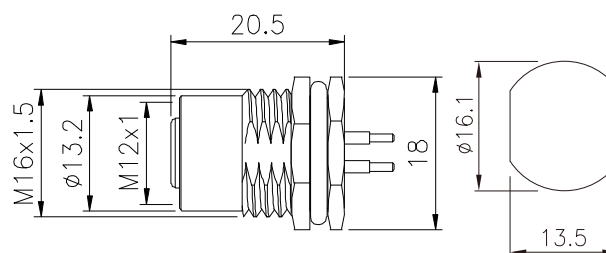

Assembly Instruction

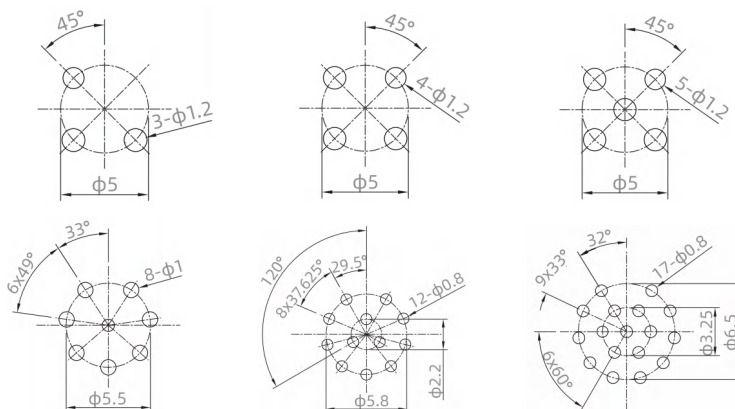
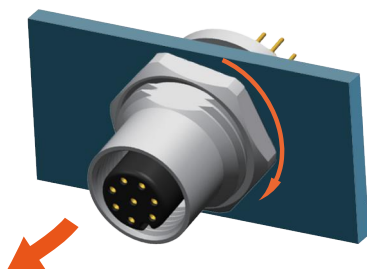

Drilling schemes female insert (PCB):



Technical Data

[illegible]

Order Information

<div> <div>  Part No. </div> </div>	<div> <div>  Model No. </div> </div>
<div> <div> M12- <div> <div></div> <div>Coded</div> </div> </div> <div> <div>-PMP-F-</div> <div> <div></div> <div>Pin No.</div> </div> </div> <div> <div>-F-M16</div> </div> </div>	<div>RG123009</div>

Remark:Contact us any time if you have custom requirements.